



Sponsored by Neptune Investment Management

Oxford University Rowing Clubs

Rowing On Circulation and Placement of Marshals

Key:

- Marshals (Yellow person icon)
- Racedesk (Green star icon)
- Senior Umpire (Red person icon)
- Non BH Island landing crews (Green arrow icon)
- Towpath (Orange line)
- Other River Traffic (Hatched area)
- Temporary Mooring (Purple M icon)
- Non-racing Circulation (Black arrow icon)

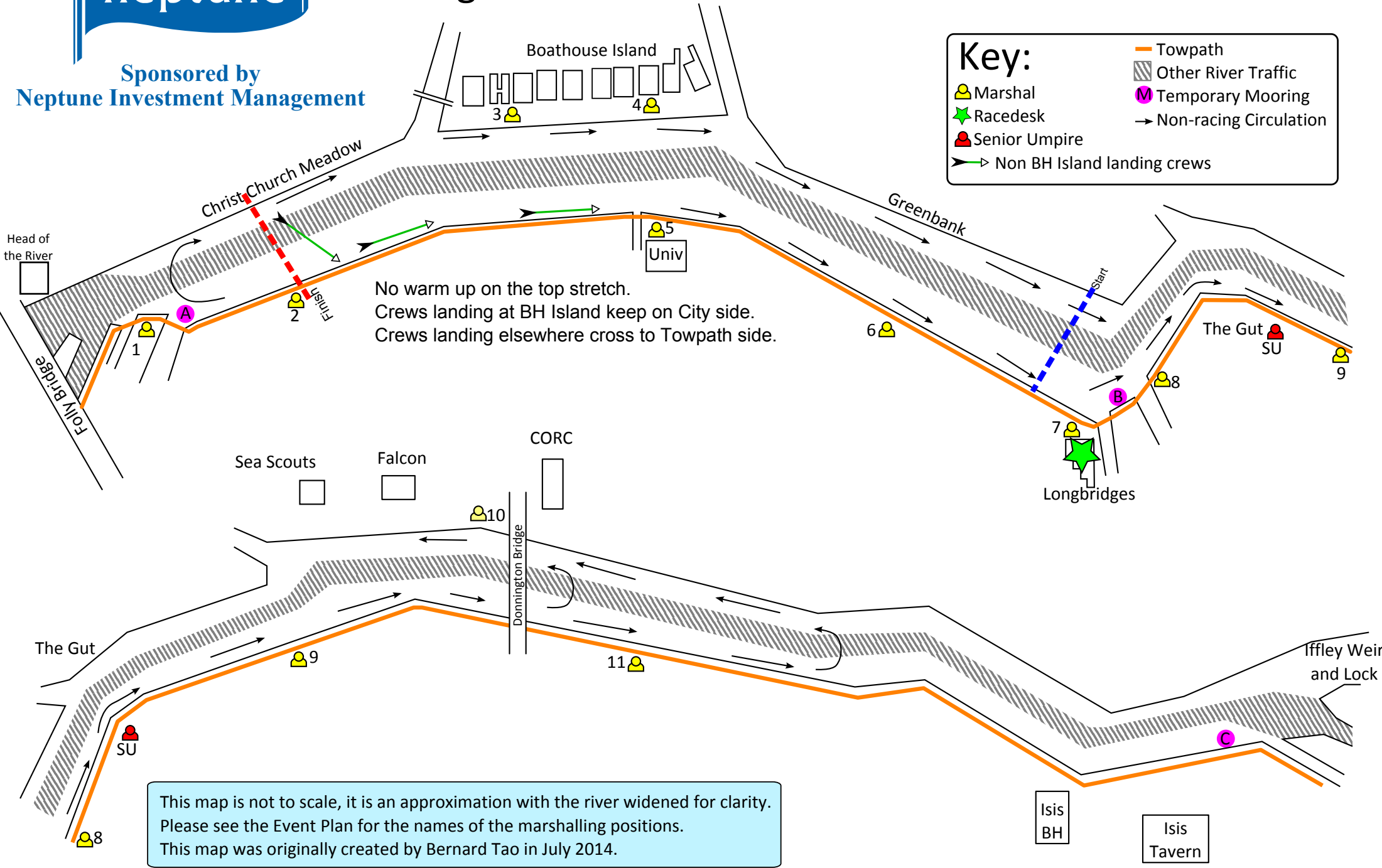

No warm up on the top stretch.
Crews landing at BH Island keep on City side.
Crews landing elsewhere cross to Towpath side.

This map is not to scale, it is an approximation with the river widened for clarity.
Please see the Event Plan for the names of the marshalling positions.
This map was originally created by Bernard Tao in July 2014.